

## SALVADOR INOX

8118.280

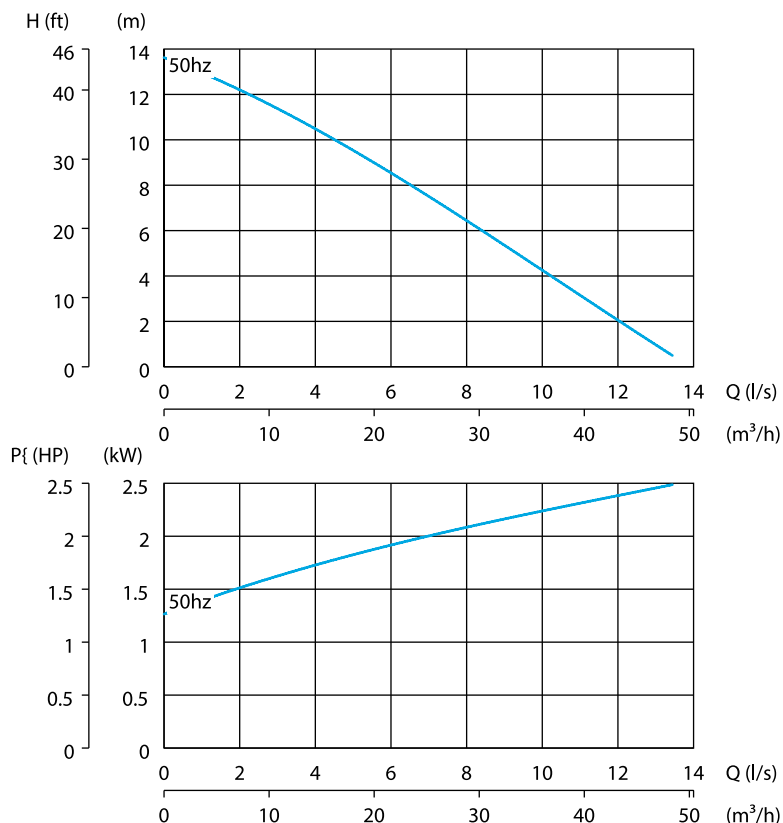
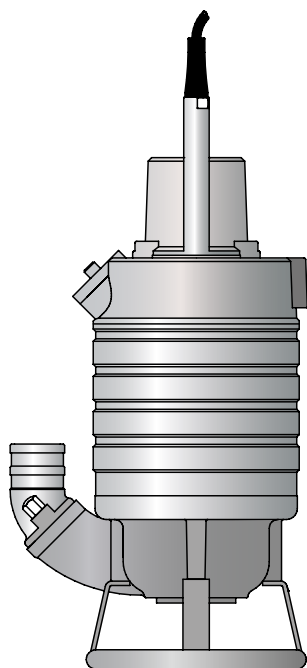

Technical Data 50 Hz		3 ph
Discharge connection		3"
Rated power P2		2.0 kW
Max. power consumption P1		2.7 kW
Shaft speed		2800 rpm
Rated current at 230V		7.7 A
Rated current at 400V		4.4 A
Rated current at 500V		3.4 A
Solids passage		50 mm
Height		645 mm
Diameter		375 mm
Weight		47 kg

## SENIOR INOX

8119.280

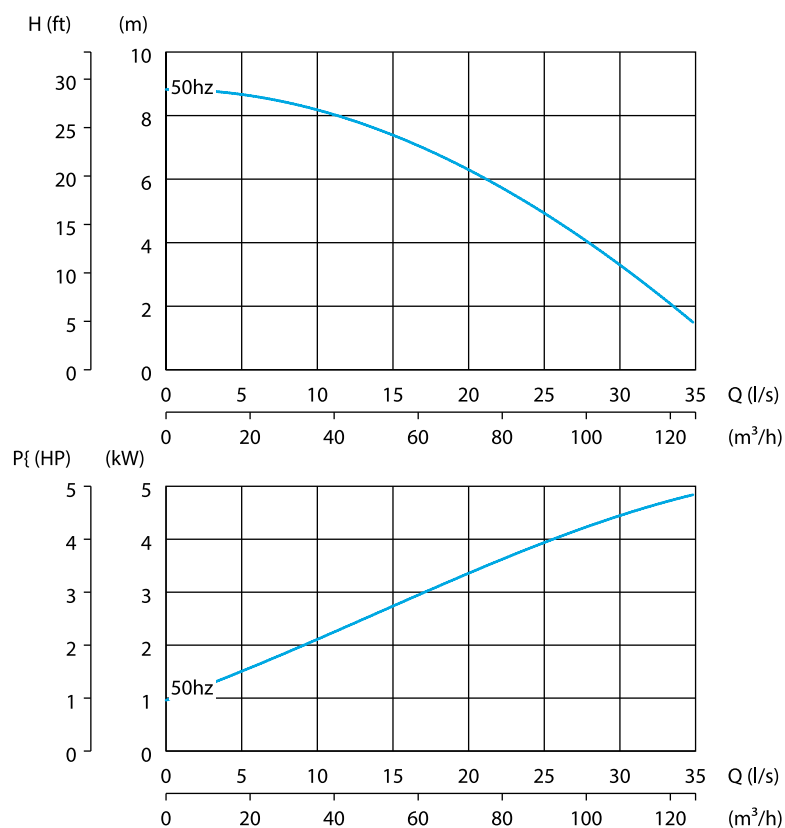
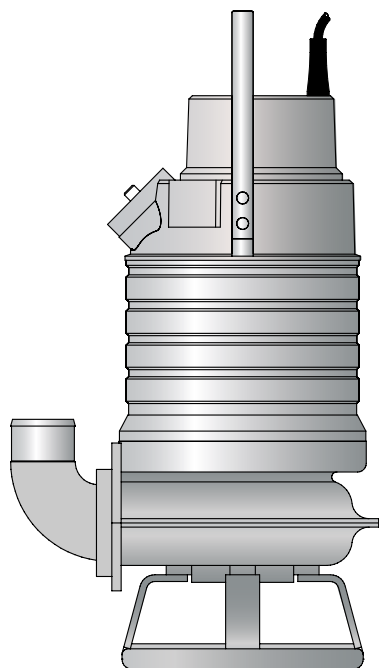

Technical Data 50 Hz		3 ph
Discharge connection		4"
Rated power P2		4.1 kW
Max. power consumption P1		5.2 kW
Shaft speed		1350 rpm
Rated current at 230V		15 A
Rated current at 400V		8.8 A
Rated current at 500V		7.7 A
Solids passage		80 mm
Height		755 mm
Diameter		480 mm
Weight		86 kg

## SANDY INOX

8120.280

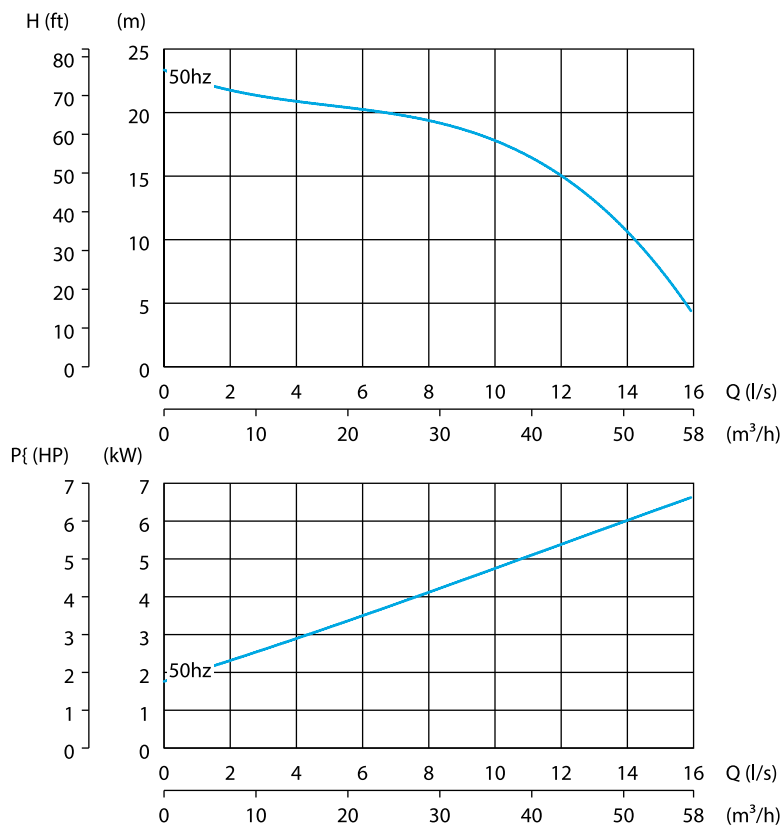
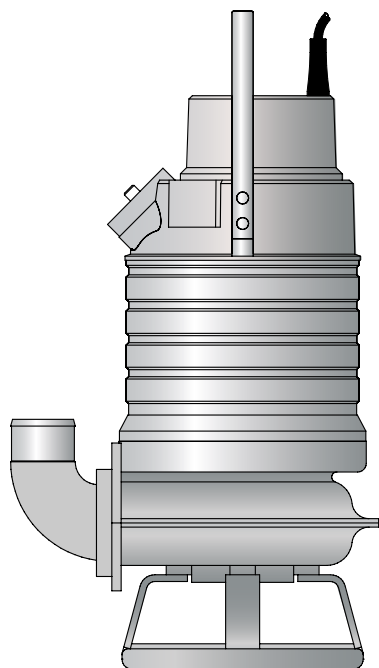

Technical Data 50 Hz		3 ph
Discharge connection		3"
Rated power P2		6.3 kW
Max. power consumption P1		7.3 kW
Shaft speed		2840 rpm
Rated current at 400V		12 A
Rated current at 500V		9.4 A
Solids passage		46 mm
Height		755 mm
Diameter		480 mm
Weight		86 kg

## Materials in drainage pumps made of stainless steel

Material	Salvador INOX	Senior INOX	Sandy INOX
<b>Upper seal</b>			
Carbon - silicon carbide	●	●	●
<b>Lower seal</b>			
Silicon carbide - silicon carbide	●	●	●
<b>Casted parts</b>			
Stainless steel (EN 10283-1.14412)	●	●	●
<b>Outer casing</b>			
Stainless steel (EN 10088-3-1.14436)	●	●	●
<b>Motor shaft</b>			
Stainless steel (EN 10088-3-1.14460)	●	●	●
<b>Impeller</b>			
Stainless steel (EN 10283-1.14412)	●	●	●
<b>Screws and nuts</b>			
Stainless steel (A4)	●	●	●
<b>O-rings</b>			
Viton rubber	●	●	●
<b>Pump housing</b>			
Nitrile rubber	●	●	●